

Terminal Dimensions

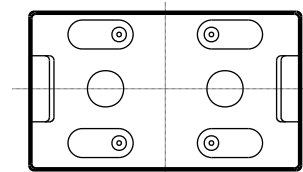
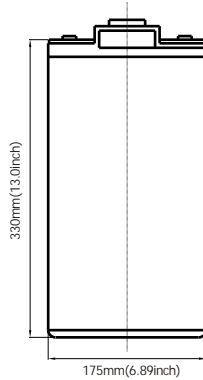
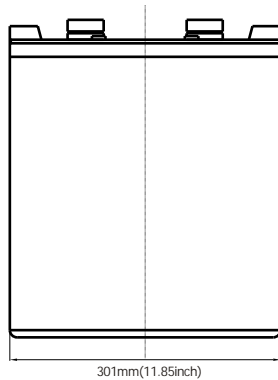

### GT 2 Series

GASTON Gt2 Series batteries utilizes thick grids of modern technology are adopted so as to guarantee the design life up to 15 years. Advanced micro porous absorbed glass matt separator - minimizes diffusion of oxygen into the separator, reducing float charge current which suppressed the corrosion rate of the positive grid and extends the life of the battery.

### Application

- Cable Television
- Communication Equipment
- Security System
- UPS
- Control Equipment
- Medical Equipment
- Emergency Power System

### General Features

- Extra long life service design (up to 15 years).
- Non-Spillable construction design.
- ABS containers and covers(UL94HB, UL94V-0) optional.
- Safety valve installation for explosion proof.
- Higher safety & reliable construction.
- Exceptional deep discharge recovery performance.
- Low self discharge characteristic.
- Flexibility design for multiple install positions.

### Construction

- Component .....Raw material
- Positive .....Lead dioxide
- Negative .....Lead
- Container .....ABS
- Cover .....ABS
- Sealant .....Epoxy Resin
- Safety valve .....EPDR
- Terminal .....Copper
- Separator .....Fiber glass
- Electrolyte .....Sulfuric acid

Battery Model	GT2-600			
Designed Floating Life	15 Years			
Capacity(25°C)	20HR(31A,1.75V)	10HR(60A,1.75V)	5HR(101A,1.75V)	1HR(365A,1.75V)
	620AH	600AH	505AH	365AH
Dimensions	Length	Width	Height	Total Height
	301mm(11.85inch)	175mm(6.89inch)	330mm(13.0inch)	365mm(14.37inch)
Approx. Weight	42Kg (92.6 lbs)			
Internal Resistance	Full charged at 25°C: 0.00063 Ohm			
Self Discharge	3% of capacity declined per month at (25°C)			
Capacity Affected by Temp.(20HR)	40°C	25°C	0°C	-15°C
	102%	100%	85%	65%
Charge Voltage(25°C)	Cycle use		Float use	
	2.3V-2.35V(-5mV/ °C), max. Current: 150A		2.25-2.27V(-3.3mV/ °C)	

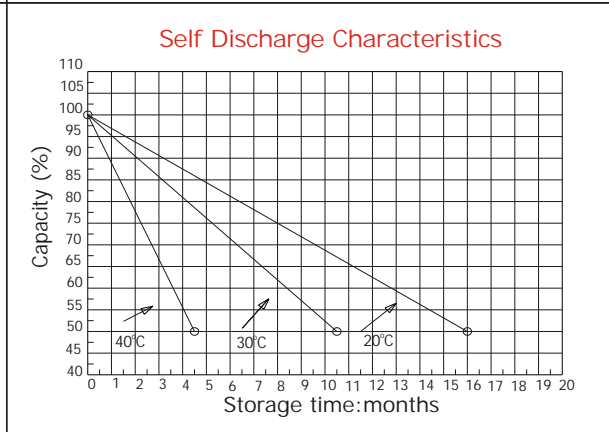
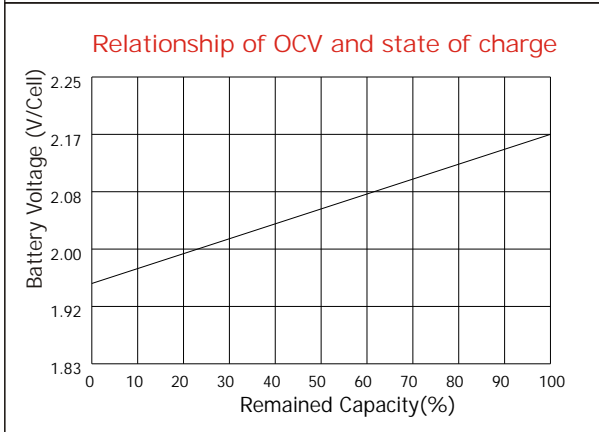
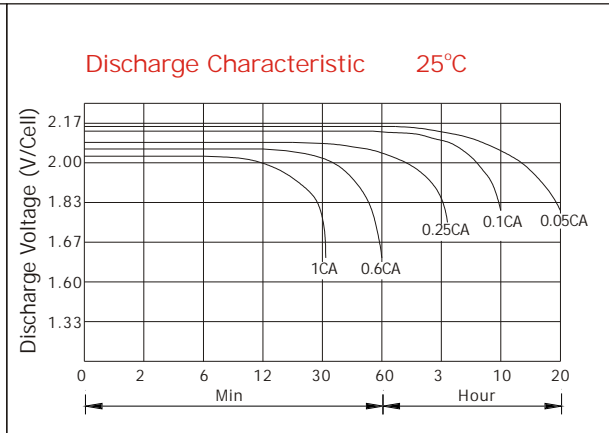
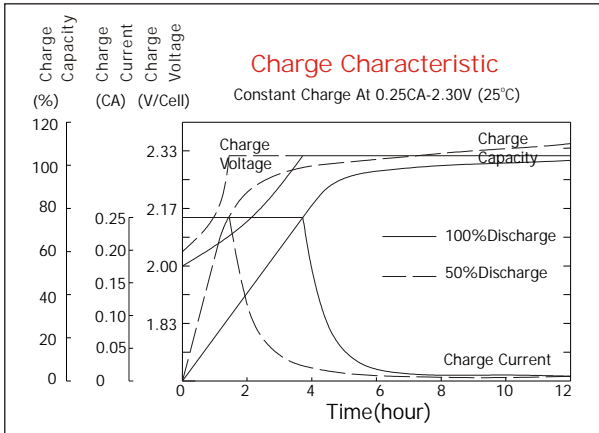

**Constant current discharge ratings-amperes at 25°C**

F.V/Time	5MIN	10MIN	15MIN	30MIN	1HR	3HR	5HR	10HR	20HR
1.60V	1620	1260	1020	654	414	189	123	63.6	32.5
1.67V	1440	1164	960	636	408	183	117	63.6	32.5
1.70V	1320	1080	900	606	390	174	111	63.0	32.2
1.75V	1212	1000	854	588	380	165	110	62.6	31.8
1.80V	1075	911	780	566	364	162	106	62.0	31.6
1.85V	792	708	639	462	297	150	99	61.5	31.3

**Constant power discharge ratings-watts at 25°C**

F.V/Time	5MIN	10MIN	15MIN	30MIN	1HR	3HR	5HR	10HR	20HR
1.60V	2542	1911	1424	1123	710	385	213	117	58.6
1.67V	2394	1800	1347	1067	680	376	209	115	57.5
1.70V	2260	1688	1269	1009	649	366	205	113	56.4
1.75V	2110	1577	1191	951	617	355	201	111	55.3
1.80V	1940	1467	1112	892	583	333	191	105	52.6
1.85V	1088	1357	1033	833	550	311	181	99.6	50.0