

HR(Hight Rate) range has been developed with high efficiency active materials to stimulate inside the battery with higher power output when the battery is discharged to a extent level. With high-density structure the inner resistance can be reduced to a relatively lower level, which will significantly improve the performance for high rate discharging when high power output service is needed.

Applications

Electric Car & Scooter	Marine Application
Toys and Spot Light	UPS
Photovoltaic Solar System	Toy

General Features

- Sealed and maintenance free operation.
- Non-Spillable construction design.
- ABS containers and covers(UL94HB, UL94V-0) optional.
- Safety valve installation for explosion proof.
- High quality and high reliability.
- Exceptional deep discharge recovery performance.
- Low self discharge characteristic.
- Flexibility design for multiple install positions.

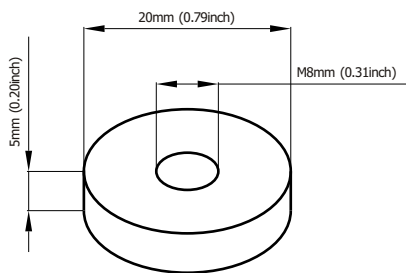

Standard Terminal Dimensions
(Optional terminal please check terminal information page)

Construction

ComponentRaw material	SealantEpoxy Resin
PositiveLead dioxide	Safety valveEPDR
NegativeLead	TerminalCopper
ContainerABS	SeparatorFiber glass
CoverABS	ElectrolyteSulfuric acid

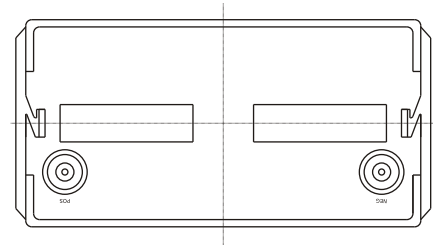
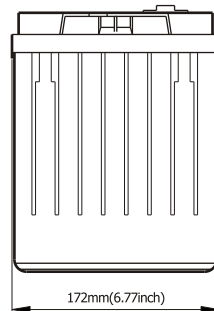
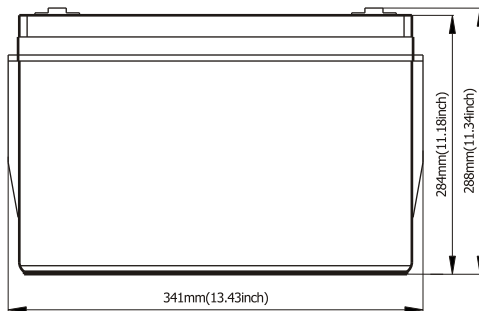

Battery Model	GT12-150HR (500W to 1.67V, 15min)			
Designed Floating Life	8-10 Years			
Capacity(25°C)	20HR(6.8A,1.75V)	10HR(12.5A,1.75V)	5HR(20.9A,1.75V)	1HR(78.9A,1.75V)
	136Ah	125Ah	104.5Ah	78.9Ah
Dimensions	Length	Width	Height	Total Height
	341mm(13.43inch)	172mm(6.77inch)	284mm(11.18inch)	288mm(11.34inch)
Approx. Weight	44.Kg (96.80 lbs)			
Internal Resistance	Full charged at 25°C: 0.0035 Ohm			
Self Discharge	3% of capacity declined per month at (25°C)			
Capacity Affected by Temp.(20HR)	40°C	25°C	0°C	-15°C
	102%	100%	85%	65%
Charge Voltage(25°C)	Cycle use		Float use	
	14.4-15V(-30mV/ °C), max. Current: 33.5A		13.6-13.8V(-20mV/ °C)	

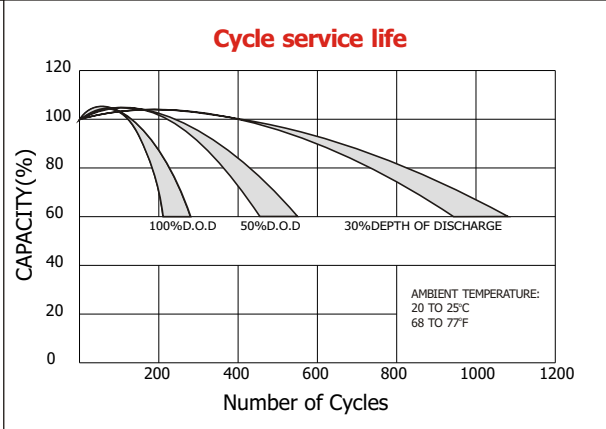
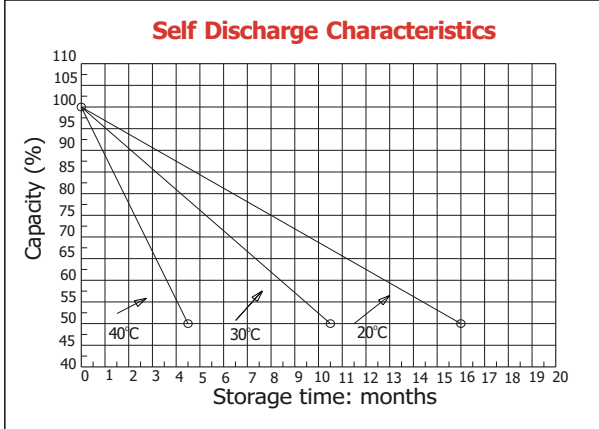
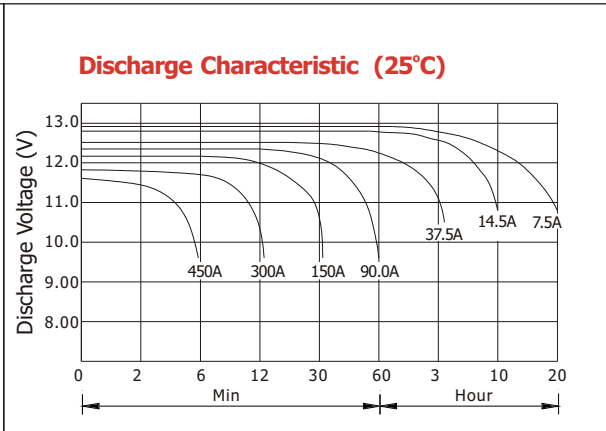
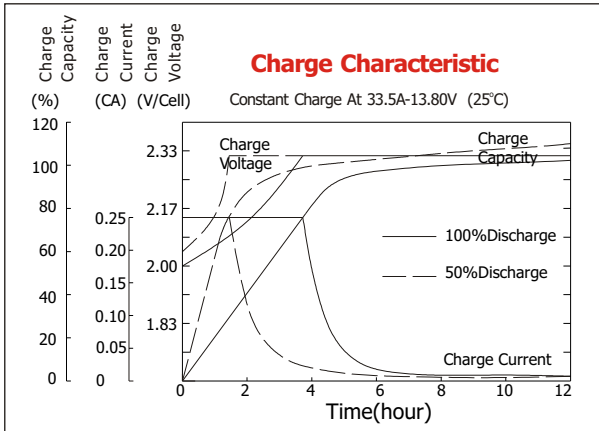

Constant current discharge ratings-amperes at 25°C

F.V/Time	5MIN	10MIN	15MIN	30MIN	1HR	3HR	5HR	8HR	10HR	20HR
1.60V	591	368	277	169	105	46.2	28.2	18.4	15.4	8.30
1.67V	555	349	267	162	104	44.4	27.6	18.1	15.2	8.01
1.70V	508	336	261	147	101	41.4	27.0	17.9	15.2	7.89
1.75V	498	326	252	140	95.9	40.1	26.4	17.7	15.1	7.68
1.80V	446	311	229	129	89.8	38.5	24.9	17.0	14.8	7.47
1.85V	393	296	206	119	83.7	37.1	23.3	16.4	14.6	7.35

Constant power discharge ratings-watts at 25°C

F.V/Time	5MIN	10MIN	15MIN	30MIN	1HR	3HR	5HR	8HR	10HR	20HR
1.60V	1037	664	506	305	190	81.9	47.7	34.7	31.6	16.6
1.67V	1000	647	500	298	189	79.3	47.5	34.5	31.4	16.0
1.70V	942	641	496	279	185	75.8	46.9	34.2	31.2	15.8
1.75V	948	639	492	271	182	74.0	46.5	33.8	30.8	15.6
1.80V	867	629	456	258	171	71.8	45.0	33.1	30.4	15.4
1.85V	787	597	413	242	161	69.7	43.6	32.4	30.0	15.2

