



HR(Hight Rate) range has been developed with high efficiency active materials to stimulate inside the battery with higher power output when the battery is discharged to a extent level. With high-density structure the inner resistance can be reduced to a relatively lower level, which will significantly improve the performance for high rate discharging when high power output service is needed.

Applications

- Electric Car & Scooter
- Toys and Spot Light
- Photovoltaic Solar System
- Marine Application
- UPS
- Toy

General Features

- Sealed and maintenance free operation.
- Non-Spillable construction design.
- ABS containers and covers(UL94HB, UL94V-0) optional.
- Safety valve installation for explosion proof.
- High quality and high reliability.
- Exceptional deep discharge recovery performance.
- Low self discharge characteristic.
- Flexibility design for multiple install positions.

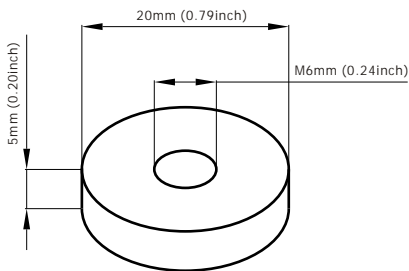

Standard Terminal Dimensions
(Optional terminal please check terminal information page)

Construction

- ComponentRaw material
- PositiveLead dioxide
- NegativeLead
- ContainerABS
- CoverABS
- SealantEpoxy Resin
- Safety valveEPDR
- TerminalCopper
- SeparatorFiber glass
- ElectrolyteSulfuric acid

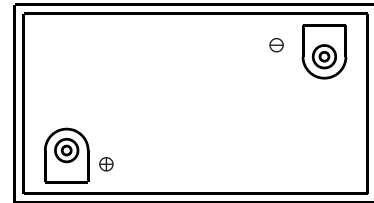
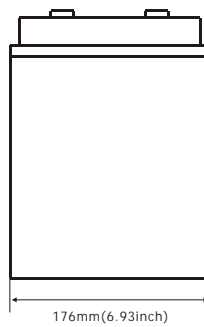
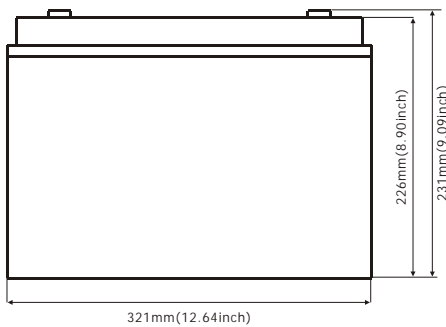

Battery Model	GT6-200HR (780W to 1.67V, 15Min)			
Designed Floating Life	8 Years			
Capacity(25°C)	20HR(11.2A,1.75V)	10HR(20.5A,1.75V)	5HR(37.4A,1.75V)	1HR(132A,1.75V)
	224AH	205AH	187AH	132AH
Dimensions	Length	Width	Height	Total Height
	320mm(12.6inch)	175mm(6.89inch)	225mm(8.86inch)	230mm(9.06inch)
Approx. Weight	34Kg (68.3 lbs)			
Internal Resistance	Full charged at 25°C: 0.003 Ohm			
Self Discharge	3% of capacity declined per month at (25°C)			
Capacity Affected by Temp.(20HR)	40°C	25°C	0°C	-15°C
	102%	100%	85%	65%
Charge Voltage(25°C)	Cycle use		Float use	
	7.2-7.5V(-15mV/ °C), max. Current: 50A		6.8-6.9V(-10mV/ °C)	



GT-HR Range

GT6-220HR 780W to 1.67V, 15Min

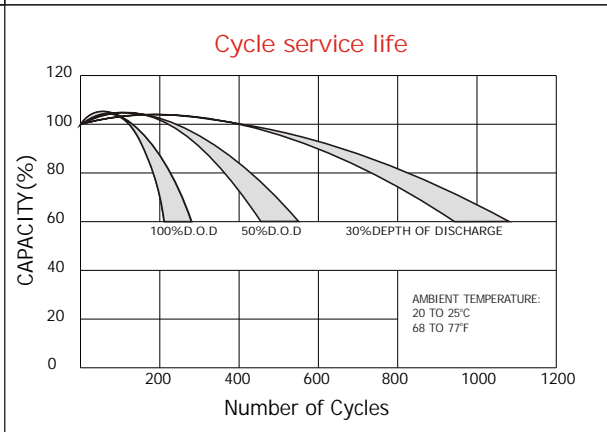
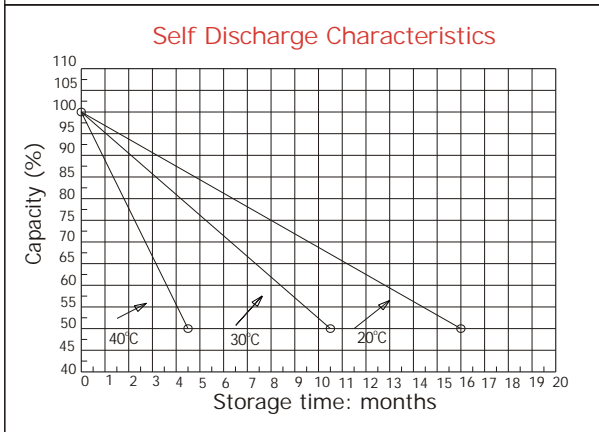
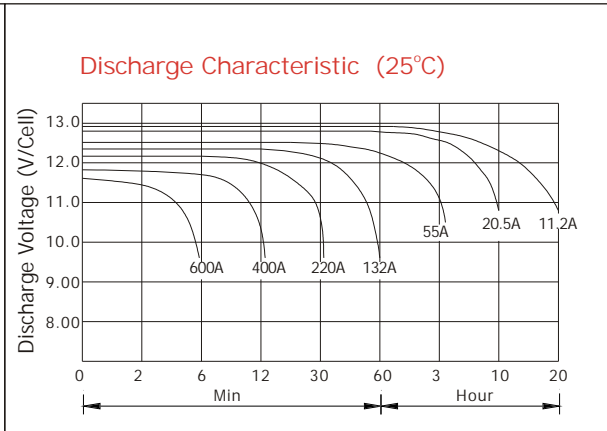
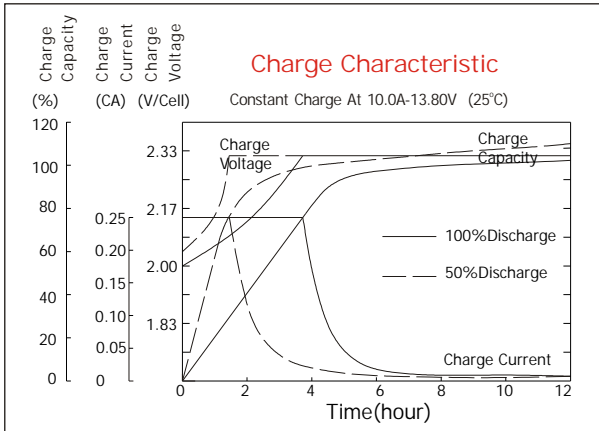

Constant current discharge ratings-amperes at 25°C

F. V/Time	5MIN	10MIN	15MIN	30MIN	1HR	3HR	5HR	10HR	20HR
1.60V	922	574	433	264	159	69.9	42.7	21.8	12.6
1.67V	865	544	416	252	157	67.2	41.8	21.6	12.1
1.70V	793	524	406	229	152	62.7	40.9	21.5	11.9
1.75V	777	508	393	218	145	60.6	40.0	21.4	11.6
1.80V	695	485	357	202	136	58.2	37.6	21.0	11.3
1.85V	614	462	321	186	127	56.1	35.2	20.7	11.0

Constant power discharge ratings-watts at 25°C

F. V/Time	5MIN	10MIN	15MIN	30MIN	1HR	3HR	5HR	10HR	20HR
1.60V	1617	1036	790	475	287	124	72.2	44.8	25.1
1.67V	1561	1009	780	465	286	120	71.9	44.5	24.2
1.70V	1469	1000	773	436	280	115	70.9	44.2	23.9
1.75V	1479	996	767	423	275	112	70.3	43.7	23.3
1.80V	1353	982	711	403	260	109	68.1	43.1	22.7
1.85V	1227	931	645	378	244	105	66.0	42.6	21.8

